

NOTE: ENTIRE TYPICAL SECTION TO BE DETAILED ON PLANS.

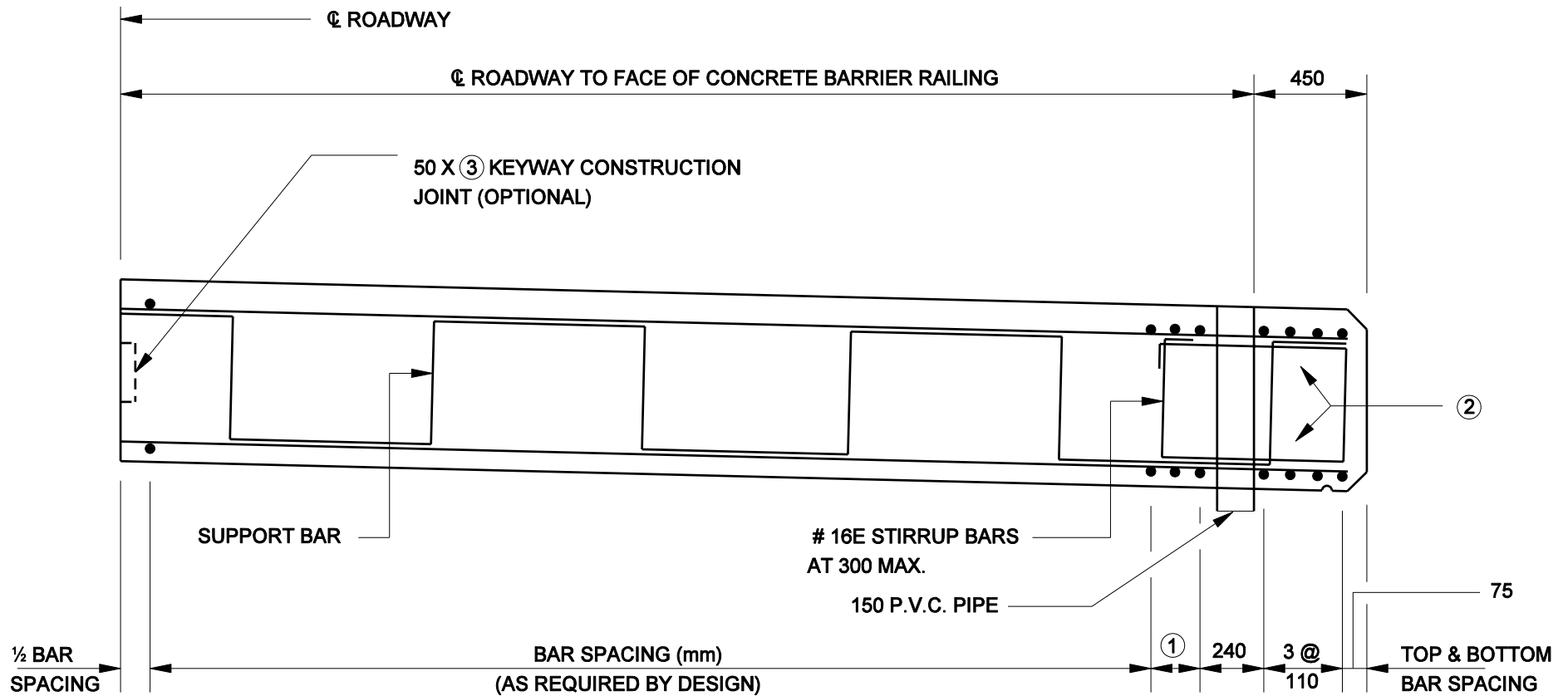

① BAR SPACING AND NUMBER OF SPACES TO BE DETERMINED TO FACILITATE A CONSTANT BAR SPACING IN REMAINDER OF SLAB.

② DESIGN EDGE BEAM IN ACCORDANCE WITH ARTICLES IN THE LRFD SPECIFICATIONS, BUT USE AS A MINIMUM THE SAME AREA OF STEEL PER METER AS IN SLAB.

③ FOR DEPTH OF KEYWAY, USE ONE-THIRD THE SLAB THICKNESS.

INTEGRAL CAPS AT SLAB SUPERSTRUCTURE
Figure 62-3E